

## MAGNETIC V-BLOCK

## SERIES 634

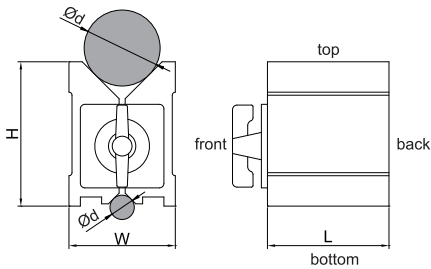

634-067-01

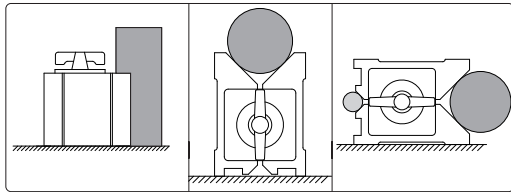

- ◆ Hold cylindrical workpiece for inspection and machining
- ◆ Top groove for large shafts
- ◆ Bottom grooves for small shafts

Code	Size(LxWxH)	For shaft range (Ød)	Magnetic force	V-grooves and back side squareness	Top side and bottom side parallelism
634-067-01	80x70x95mm	6 - 67mm	64kgf	10µm	10µm
634-067-02	100x70x95mm	6 - 67mm	80kgf	10µm	10µm
634-067-03	120x70x95mm	6 - 67mm	96kgf	10µm	10µm

## MAGNETIC V-BLOCK SET

## SERIES 635

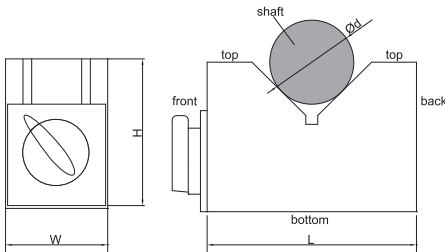

635-150-01

- ◆ Hold cylindrical workpieces for inspection, not suitable for machining due to weak magnetic force
- ◆ Two V-blocks per set



Code	Size(LxWxH)	Range of shafts (Ød)	Magnetic force	Parallelism of V groove to bottom and back sides	Height difference of a matched pair
635-070-01	70x40x50mm	6 - 46mm	8kgf	10µm	10µm
635-150-01	150x50x100mm	6 - 125mm	14kgf	10µm	10µm